

HM-Einsatz nach DIN 8012

Carbide tips DIN 8012

Mises en métal dur DIN 8012

MK MT CM	Best. Nr. Order no. no. de com.	Abmessungen Dimensions dimensions			
		A	B	D	P
1	H-01.011	80	26.5	12.2	7
2	H-02.011	100	36	18	7
3	H-03.011	125	44	24.1	11
4	H-04.011	160	57.5	31.6	14
5	H-05.011	200	70.5	44.7	18

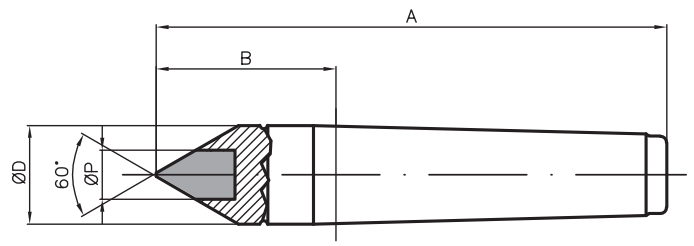

60° Spitze in Vollhartmetall

Full carbide Centres

Pointes pleine en métal dur

MK MT CM	Best. Nr. Order no. no. de com.	Abmessungen Dimensions dimensions		
		A	B	D
2	H-02.061	100	36	18
	H-02.062	112	48	18
3	H-03.061	125	44	24.1
	H-03.062	141	60	24.1
4	H-04.061	160	57.5	31.6
	H-04.062	180	77.5	31.6
5	H-05.061	200	70.5	44.7
	H-05.062	230	100.5	44.7

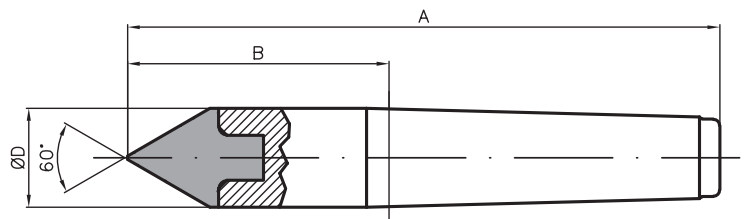

Stumpf mit Hartmetallring

Bull nose carbide Centres

Pointes tronconique en métal dur

MK MT CM	Best. Nr. Order no. no. de com.	Abmessungen Dimensions dimensions			
		A	B	D	d
2	H-02.201	95	31	45	25
	H-02.211	95	31	59	39
	H-02.221	95	31	73	53
3	H-03.101	127	46	34	12
	H-03.201	112	31	45	25
	H-03.211	112	31	59	39
	H-03.221	112	31	73	53
4	H-03.231	112	31	87	67
	H-04.201	135	32.5	45	25
	H-04.211	135	32.5	59	39
5	H-04.221	135	32.5	73	53
	H-04.231	135	32.5	87	67
	H-04.241	135	32.5	100	80
	H-05.211	162	32.5	59	39
5	H-05.221	162	32.5	73	53
	H-05.231	162	32.5	87	67
	H-05.241	162	32.5	100	80

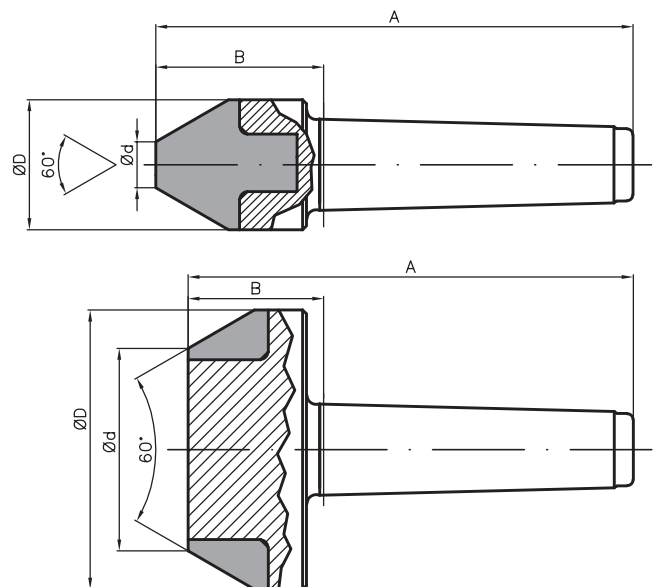

Abgeflachte Zentrierspitzen

Half point carbide Centres

Demi-pointes en métal dur

MK MT CM	Best. Nr. Order no. no. de com.	Abmessungen Dimensions dimensions					
		A	B	C	D	H	P
1	H-01.311	80	26.5	22	12.2	1.5	7
2	H-02.301	100	36	30	18	4	7
	H-02.311	100	36	30	18	2	7
	H-02.312	112	48	42	18	2	7
3	H-03.301	125	44	38	24.1	6	11
	H-03.311	125	44	38	24.1	3	11
	H-03.312	141	60	54	24.1	3	11
4	H-04.301	160	57.5	50	31.6	7.5	14
	H-04.311	160	57.5	50	31.6	5	14
	H-04.312	180	77.5	70	31.6	5	14
5	H-05.301	200	70.5	63	44.7	9.5	18
	H-05.311	200	70.5	63	44.7	7	18
	H-05.312	230	100.5	93	44.7	7	18

